

CONNECTORS

PUMP SEGMENTS

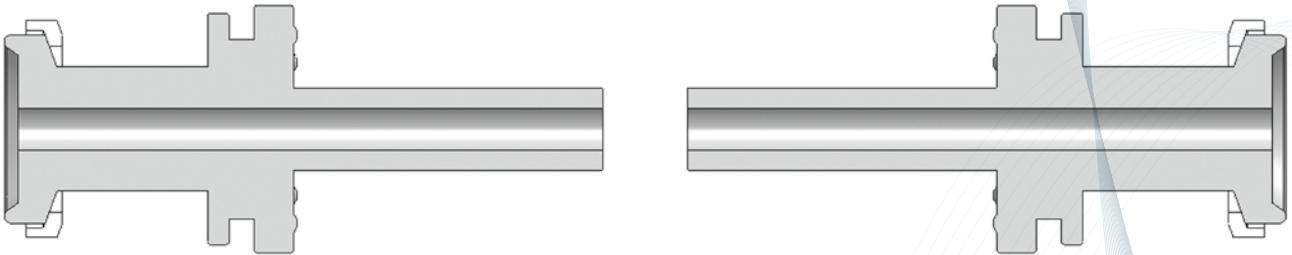

Connectors Item number	L2	L1	TC	ID	WS
699.000.K05.	346mm	313mm	25mm	1.6mm	2.4mm
699.000.K06.	346mm	313mm	25mm	3.2mm	2.4mm
699.000.K07.	346mm	313mm	25mm	4.8mm	2.4mm
699.000.K08.	346mm	313mm	25mm	6.4mm	2.4mm
699.000.K09.	346mm	313mm	25mm	8.0mm	2.4mm
699.000.K10.	346mm	313mm	25mm	9.6mm	2.4mm

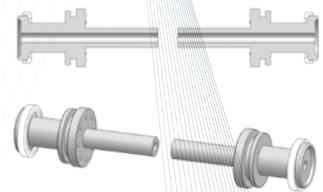

BENEFITS

- short, easy-to-replace pump segments for squeeze-bulb pumps
- completely free from dead space and reductions / expansions
- with captive integrated seal and supporting ring (no additional TC seal)
- USP Class VI / FDA-compliant
- ready-to-use system manufactured under cleanroom conditions, double-packaged and gamma-sterilised
- platinum-cured LSR (liquid silicone rubber)

Connectors pump segments are suitable for many conventional squeeze-bulb pump heads. For more information, please contact Connectors.

BRIEF DESCRIPTION

Pump tubes are subjected to very heavy mechanical loads. Connectors pump segments are highly resistant and very easy to replace. Only the section of the pump segment that is put under the most severe stress is replaced.

